

Take-up Units

UCCT2 (Normal-duty)

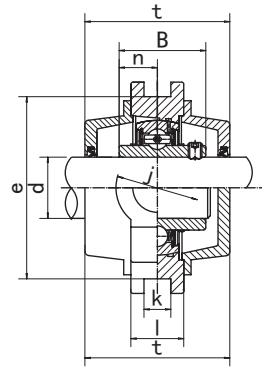
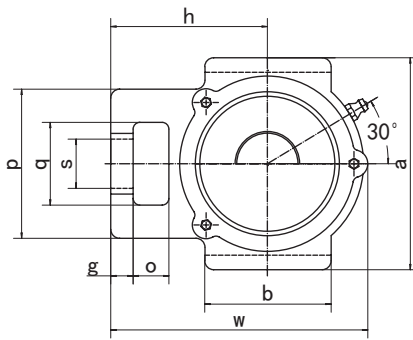

Unit NO.	Dimensions (mm / in.)																	Bearing No.	Housing No.	Weight (kg)
	d	o	g	p	q	s	b	k	e	a	w	j	l	h	t	B	n			
UCCT204	20	16	10	51	32	19	51	12	76	89	94	32	21	61	62	31	12.7	UC204	CT204	0.68
204-12	3/4	5/8	25/64	1-1/64	1-1/4	3/4	2-1/64	15/32	2-63/64	3-1/2	3-11/16	1-1/4	53/64	2-13/32	2-7/16	1.2205	0.500	UC204-12		0.68
UCCT205	25	16	10	51	32	19	51	12	76	89	100	32	24	62	70	34.1	14.3	UC205	CT205	0.93
205-13	13/16																	UC205-13		0.97
205-14	7/8	5/8	25/64	1-1/64	1-1/4	3/4	2-1/64	15/32	2-63/64	3-1/2	3-15/16	1-1/4	15/16	2-7/16	2-3/4	1.3425	0.563	UC205-14		0.96
205-15	15/16																	UC205-15		0.94
205-16	1																	UC205-16		0.93
UCCT206	30	16	10	56	37	22	57	12	89	102	113	37	28	70	74	38.1	15.9	UC206		CT206
206-17	1-1/16																	UC206-17	1.34	
206-18	1-1/8	5/8	25/64	2-7/32	1-15/32	55/64	2-1/4	15/32	3-1/2	4-1/64	4-29/64	1-29/64	1-3/32	2-3/4	2-29/32	1.5000	0.626	UC206-18	1.35	
206-19	1-3/16																	UC206-19	1.33	
206-20	1-1/4																	UC206-20	1.32	
UCCT207	35	16	13	64	37	22	64	12	89	102	129	37	30	78	80	42.9	17.5	UC207	CT207	2.00
207-20	1-1/4																	UC207-20		2.06
207-21	1-5/16	5/8	33/64	2-33/64	1-15/32	55/64	2-33/64	15/32	3-1/2	4-1/64	5-5/64	1-29/64	1-3/16	3-5/64	3-5/32	1.6890	0.689	UC207-21		2.03
207-22	1/3/8																	UC207-22		2.00
207-23	1-7/16																	UC207-23		1.97
UCCT208	40	19	16	83	49	29	83	16	102	114	144	49	33	89	90	49.2	19	UC208	CT208	2.81
208-24	1-1/2	3/4	5/8	3-17/64	1-15/16	1-9/64	3-17/64	5/8	4-1/64	4-31/64	5-43/64	1-15/16	1-19/64	3-1/2	3-35/64	1.9370	0.748	UC208-24		2.85
208-25	1-9/16																	UC208-25		2.82
UCCT209	45	19	16	83	49	29	83	16	102	117	145	49	35	87	90	49.2	19	UC209	CT209	2.80
209-26	1-5/8																	UC209-26		2.90
209-27	1-11/16	3/4	5/8	3-17/64	1-15/16	1-9/64	3-17/64	5/8	4-1/64	4-39/64	5-45/64	1-15/16	1-3/8	3-27/64	3-35/64	1.9370	0.748	UC209-27		2.86
209-28	1-3/4																	UC209-28		2.82
UCCT210	50	19	16	83	49	29	86	16	102	117	151	49	37	90	98	51.6	19	UC210	CT210	3.06
210-29	1-13/16																	UC210-29		3.18
210-30	1-7/8	3/4	5/8	3-17/64	1-15/16	1-9/64	3-25/64	5/8	4-1/64	4-39/64	5-5/16	1-15/16	1-27/64	3-35/64	3-55/64	2.0315	0.748	UC210-30		3.13
210-31	1-15/16																	UC210-31		3.08
210-32	2																	UC210-32		3.04
UCCT211	55	25	19	102	64	35	95	22	130	146	174	64	38	106	100	55.6	22.2	UC211	CT211	4.17
211-32	2																	UC211-32		4.32
211-33	2-1/16	63/64	3/4	4-1/64	2-1/32	1-3/8	3-3/4	55/64	5-1/8	5-3/4	6-27/32	2-33/64	1-1/2	4-11/64	3-15/16	2.1890	0.874	UC211-33		4.26
211-34	2-1/8																	UC211-34		4.21
211-35	2-3/16																	UC211-35		4.15
UCCT212	60	32	19	102	64	35	102	22	130	146	194	64	42	119	114	65.1	25.4	UC212	CT212	5.87
212-36	2-1/4																	UC212-36		6.00
212-37	2-5/16	1-17/64	3/4	4-1/64	2-1/32	1-3/8	4-1/64	55/64	5-1/8	5-3/4	7-41/64	2-33/64	1-21/32	4-11/16	4-31/64	2.5630	1	UC212-37		5.92
212-38	2-3/8																	UC212-38		5.85
212-39	2-7/16																	UC212-39		5.78
UCCT213	65	32	21	111	70	41	121	26	151	167	224	70	44	137	118	65.1	25.4	UC213	CT213	8.18
213-40	2-1/2	1-17/64	53/64	4-3/8	2-3/4	1-39/64	4-49/64	1-1/32	5-15/16	6-37/64	8-13/16	2-3/4	1-47/64	5-25/64	4-41/64	2.5630	1	UC213-40		8.27
213-41	2-9/16																	UC213-41		8.18
UCCT214	70	32	21	111	70	41	121	26	151	167	224	70	46	137	134	74.6	30.2	UC214	CT214	8.30
214-42	2-5/8																	UC214-42		8.51
214-43	2-11/16	1-17/64	53/64	4-3/8	2-3/4	1-39/64	4-49/64	1-1/32	5-15/16	6-37/64	8-13/16	2-3/4	1-13/16	5-25/64	5-9/32	2.9370	1.189	UC214-43		8.41
214-44	2-3/4																	UC214-44		8.31
UCCT215	75	32	21	111	70	41	121	26	151	167	232	70	48	140	136	77.8	33.3	UC215	CT215	9.31
215-45	2-13/16																	UC215-45		9.56
215-46	2-7/8	1-17/64	53/64	4-3/8	2-3/4	1-39/64	4-49/64	1-1/32	5-15/16	6-37/64	9-9/64	2-3/4	1-57/64	5-33/64	5-23/54	0.0630	1.311	UC215-46		9.45
215-47	2-15/16																	UC215-47		9.34
215-48	3																	UC215-48		9.22
UCCT216	80	32	21	111	70	41	121	26	165	184	236	70	51	140	146	82.6	33.3	UC216	CT216	10.90
216-49	3-1/16	1-17/64	53/64	4-3/8	2-3/4	1-39/64	4-49/64	1-1/32	6-1/2	7-1/4	9-19/64	2-3/4	2-1/64	5-33/64	5-3/4	3.2520	1.311	UC216-49		11.08
216-50	3-1/8																	UC216-50		10.95
216-51	3-3/16																	UC216-51		10.82
UCCT217	85	38	29	124	73	48	157	30	173	198	263	73	54	162	150	85.7	34.1	UC217	CT217	13.26
217-52	3-1/4																	UC217-52		13.48
217-53	3-5/16	1-1/2	1-9/64	4-7/8	2-7/8	1-57/64	6-3/16	1-3/16	6-13/16	7-51/64	10-23/64	2-7/8	2-1/8	6-3/8	5-29/32	3.3740	1.343	UC217-53		13.34
217-55	3-7/16																	UC217-55		13.05